

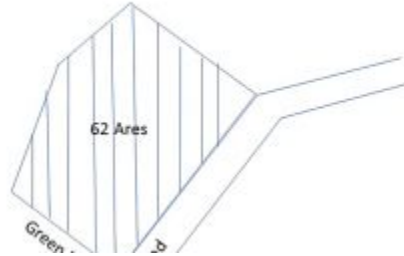

BALIHOMIIMMO
PROPERTY



LAND SIZE 820 m ²
VIEW Garden
SURROUNDING Commercial Area
SPLITABLE No
LEASEHOLD PERIOD 24 year



OFFICE & LAND FOR SALE LEASEHOLD IN UMALAS - JU166

General Information

Price on Request
Land Size : 820 m²
Surrounding : Commercial Area
Splitable :
Road Access : Yes
View : Garden
Road Width (meter) : 0 m
Zoning : Residential
Leasehold Period : 24 year

Phone : +6282194359401
Email : info@bali-home-immo.com

www.bali-home-immo.com

  Bali Home Immo